

Introduction

Congratulations on purchasing the Targus SoundUP™ High Definition Sound Enhancer. This in-line sound enhancer provides rich three dimensional sound to virtually any audio source. Simply plug SoundUP into the headphone jack of virtually any audio source to enhance your favorite music. SoundUP is also a powered earphone splitter that allows two users to listen without splitting the signal or volume.

List of Contents

- Sound Enhancer
- AAA Battery
- Quick Start Guide

Operating SoundUP

Simply plug the soundUP into the headphone jack of your audio source and connect your headphones to either jack. SoundUP uses a single AAA battery for hours of continuous play.

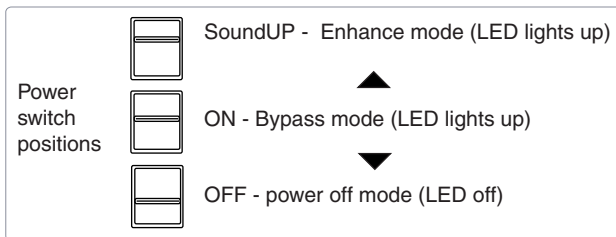

The volume control switch is located on the side of the enhancer. Turn the wheel to increase or decrease the volume.

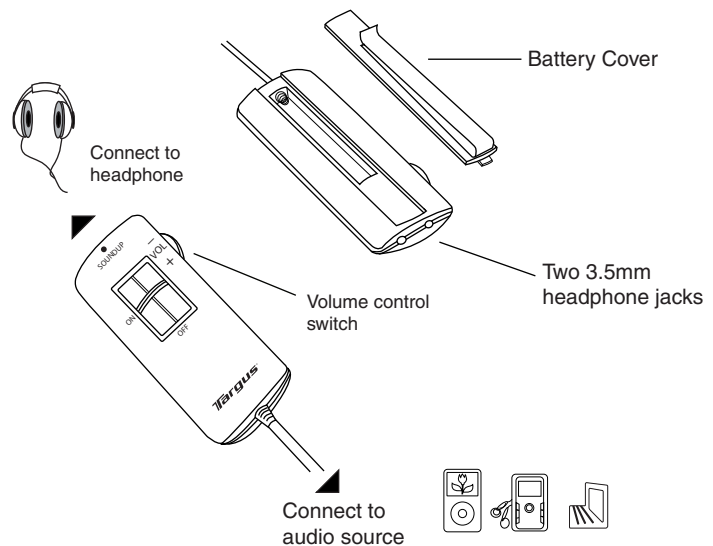

Installing the battery

- Remove the battery cover from the back of SoundUP by sliding the clip downwards.
- Insert the supplied battery, making sure that the positive (+) and negative (-) ends of the battery match the polarity in the battery housing.
- Snap the battery cover back into position.

Technical Support

For technical questions, please visit:
Internet: <http://www.targus.com/support.asp>

Product Registration

Targus recommends that you register your Targus accessory shortly after purchasing it. To register your Targus accessory, go to: <http://www.targus.com/registration.asp>

You will need to provide your full name, email address, phone number, and company information (if applicable).

Warranty

Targus warrants this product to be free from defects in materials and workmanship for one years. If your Targus accessory is found to be defective within that time, we will promptly repair or replace it. This warranty does not cover accidental damage, wear and tear, or consequential or incidental loss. Under no conditions is Targus liable for loss of, or damage to a computer; nor loss of, or damage to, programs, records, or data; nor any consequential or incidental damages, even if Targus has been informed of their possibility. This warranty does not affect your statutory rights.

Regulatory Compliance

This device complies with Part 15 of the FCC Rules. Operation is subject to the following two conditions: (1) This device may not cause harmful interference, and (2) This device must accept any interference received, including interference that may cause undesired operation.

FCC Statement

Tested to Comply

This equipment has been tested and found to comply with the limits of a Class B digital device, pursuant to Part 15 of the FCC Rules. These limits are designed to provide reasonable protection against harmful interference in a residential installation. This equipment generates, uses, and can radiate radio frequency energy and if not installed and used in accordance with the instructions, may cause harmful interference to radio communications. However, there is no guarantee that interference will not occur in a particular installation. If this equipment does cause harmful interference to radio or television reception, which can be determined by turning the equipment off and on, the user is encouraged to try to correct the interference by one or more of the following measures:

- Reorient or relocate the receiving antenna
- Increase the separation between the equipment and receiver
- Connect the equipment into an outlet on a circuit different from that to which the receiver is connected
- Consult the dealer or an experienced radio/TV technician for help